



## HOBART BUILDING 2 WARDS PLACE LONDON, E14 9XJ

£2,500 PCM

Situated on the 25th floor of the highly sought-after Wardian development in the heart of Canary Wharf, this exceptional river-facing apartment offers stylish living with breathtaking views across the Thames and London skyline. The property features a bright and spacious open-plan kitchen and living area, a well-proportioned bedroom with built-in storage, and a sleek, contemporary shower room. A standout feature is the expansive private garden balcony, providing a tranquil outdoor space with stunning panoramic river and city views.

Residents benefit from exclusive membership to The Wardian Club, granting access to an impressive range of first-class amenities. These include a private dining suite, rooftop observatory and bar, a state-of-the-art gym, and a dedicated yoga studio, perfect for both relaxation and entertaining.

**DouglasPryce**

## Wards Place, E14 9XJ

Approx Gross Internal Area = 36.6 sq m / 394 sq ft

Balcony = 9.73 sq m / 105 sq ft

Total = 46.33 sq m / 499 sq ft

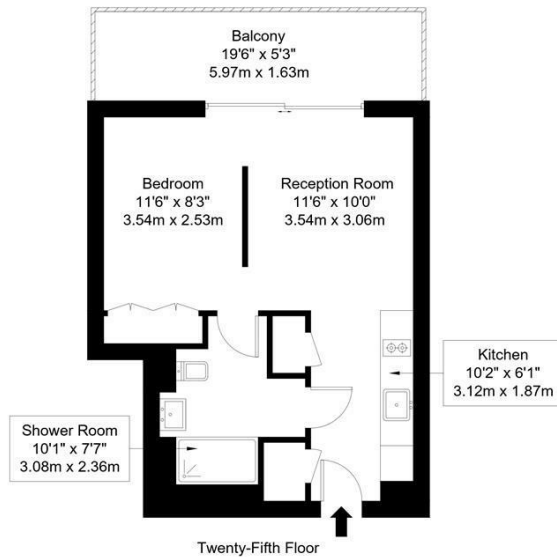

Ref :

Copyright **BLEU  
PLAN**

The Floor plan is not to scale and measurements and areas shown are approximate and therefore should be used for illustrative purposes only. The plan has been prepared in accordance with the RICS code of Measuring Practice and whilst we have confidence in the information produced it must not be relied on. Maximum lengths and widths are represented on the floor plan. If there is any aspect of particular importance, you should carry out or commission your own inspection of the property.  
Copyright @ BLEUPLAN



Energy Efficiency Rating		Current	Potential
Very energy efficient - lower running costs			
(92 plus) <b>A</b>			
(81-91) <b>B</b>			
(69-80) <b>C</b>			
(55-68) <b>D</b>			
(39-54) <b>E</b>			
(21-38) <b>F</b>			
(1-20) <b>G</b>			
Not energy efficient - higher running costs			
<b>England &amp; Wales</b>		EU Directive 2002/91/EC	

Agents Note: Whilst every care has been taken to prepare these particulars, they are for guidance purposes only. All measurements are approximate and are for general guidance purposes only and whilst every care has been taken to ensure their accuracy, they should not be relied upon and potential buyers/tenants are advised to recheck the measurements

Lettings  
Verdant Lane  
London  
SE6 1LF

07887933642  
glenn@douglaspryce.co.uk  
www.douglaspryce.co.uk

**DouglasPryce**